

# Phase 1

## Main Building - Second Floor

### Preliminary Sign Count

- Kiosk - 1
- Directory with Map - 10
- Stairs and Exits - 5
- Elevator - 1
- Restrooms - 1

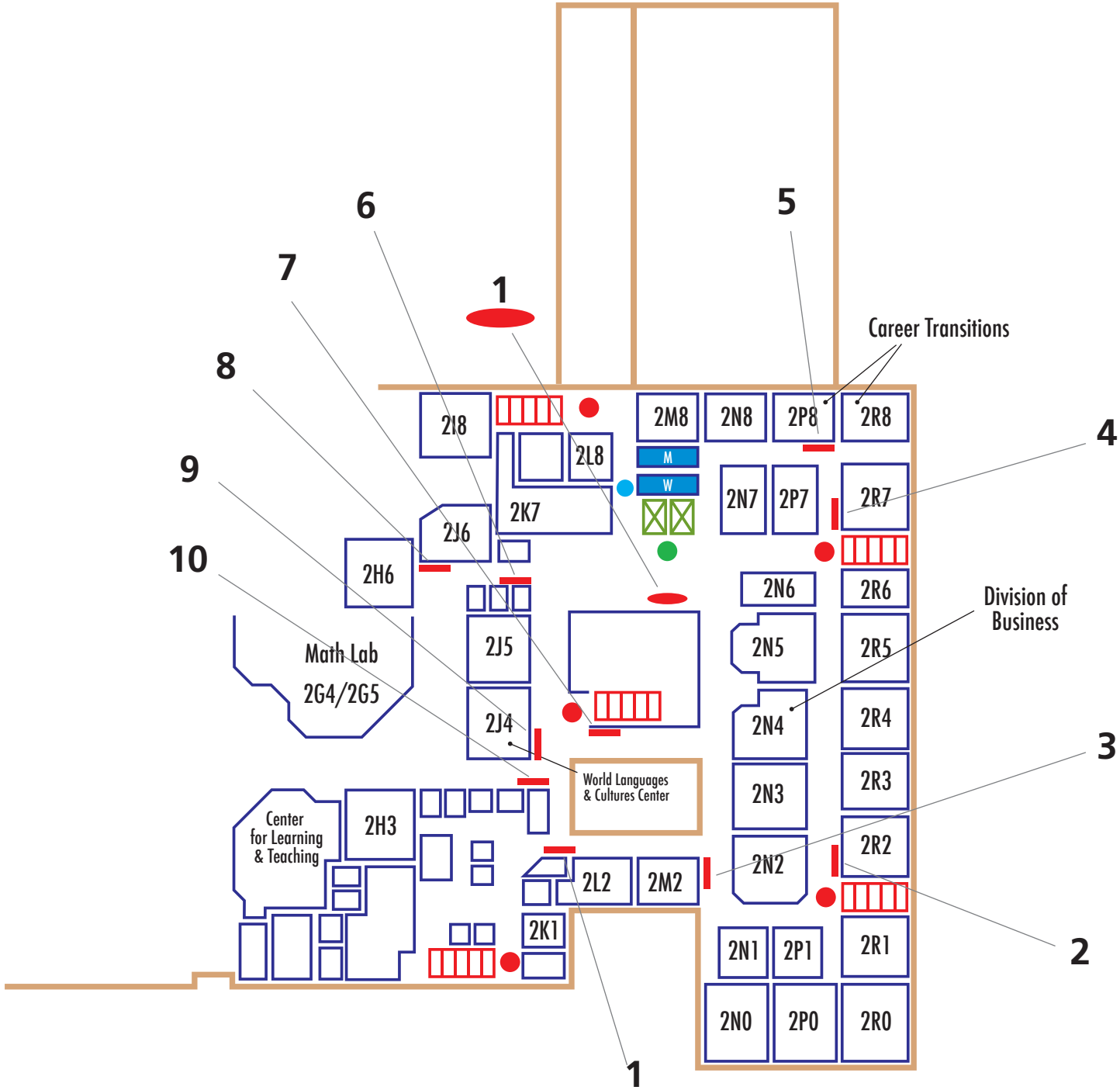

- Kiosk
- Directory & Map
- Stairs & Exits
- Restrooms
- Elevators
- Safer Area